



# Wind River

HALF  
TON  
Series

## Wind River

"Follow the Wind to Your Dreams"



**FOUR  
SEASONS**

- \*\*\* All New "Armor Shield" Feather-Light Construction
- \*\*\* Durable Fiberglass Front Cap  
with Diamond Plate Protection & LED Lights
- \*\*\* Stainless Steel Appliances / Comfort Suede Furniture
- \*\*\* Shock Absorbing Suspension / Power Tongue Jack / Ladder
- \*\*\* Halogen Ceiling Lights / XL Fridge (20% More Groceries)

 **OUTDOORS RV**  
MANUFACTURING



# Wind River

"Follow the Wind to Your Dreams"



250RLSW – Two residential comfort style lounge recliners with three panoramic picture windows for enjoying the beautiful scenery. . .luxury features abound here. . .comfort style sleeper sofa, two tone day/night shades, bullet reading lights, halogen ceiling lights, marble slate designed flooring, and the list goes on. . .today's RV buyer desires comfort and amenities just like home and with the 2012 WindRiver they will be able to sit back, relax and take in all that our backyard "The Outdoors" has to offer!



## THE BATHROOM–

The WindRiver does not take shortcuts even in here...notice the built-in wood medicine cabinet, bathroom hairdryer, porcelain toilet, glass shower enclosure, and even this model has a window for additional natural light...full function bathroom is an understatement!



THE KITCHEN – Stainless steel appliances, 22" sealed burner range, pot & pan drawer, XL fridge (20% more groceries), metal full extension drawer guides, arched high profile picture window, ribbed glass gourmet cabinet, incredible counter-space, and the list goes on...



...with one look at the inside of the **All New** 2012 WindRiver you will see that the term Luxury-Lite home away from home fits perfectly. From the Mountain Alder interior to the Marble Slate designed flooring one notices that this is not your ordinary travel trailer. Add the Comfort Suede furniture, halogen ceiling lights, and the gourmet kitchen with stainless steel appliances and soon you will be saying that the Outdoors with family and friends feels just like home!

**STORAGE, STORAGE, STORAGE** – Here at Outdoors RV we pride ourselves on storage both on the outside and on the inside of our products. This picture to the right shows a huge double door wardrobe with four drawers that is just in the hallway of this floorplan.

**THE BEDROOM** – Two full size wardrobes, full length headboard shelf, nightstands on both sides of the bed, three convenient plug-ins, individual bullet reading lights, "Dream Soft" Pillow Top Mattress, bedroom pillows, and incredible under-bed storage...so many RV manufacturers take this part of the RV for granted...not Outdoors RV – we are active users of the products we produce and this was one area we knew was extremely important to the seasoned RVer!



## Wind River

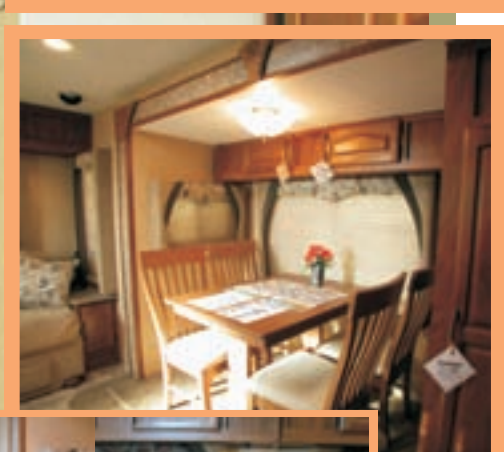

**ENTERTAINMENT AREA** – 26" – 32" LCD Mobile Designed TV's with iPod docking station, DVD System, Sub Woofer, and Home theatre Speakers. . . the picture above is a floorplan that has a swivel design for viewing from either the living room or the bedroom. . . **THE DINETTE** – Either a booth dinette with XL full size drawers under both benches or the free standing dinette with high back aero dinette chairs with storage – we know that every customer has different camping needs but one thing for sure: storage is king!

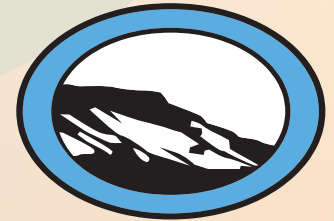

# Wind River

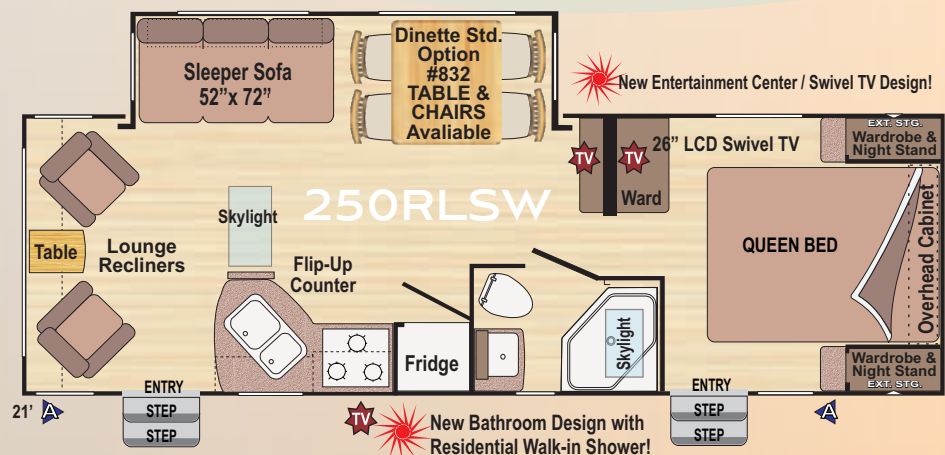

\*Specifications are subject to change without notice.



# Wind River Floor Plans



**FOUR SEASONS**

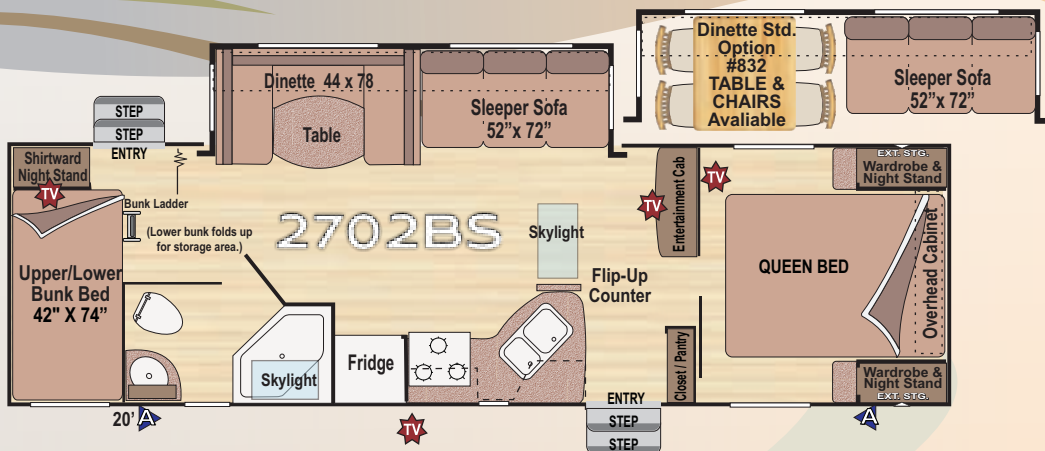

*Welcome to the Outdoors!*



Indicates pre wired locations where TV's can be installed.  
All livingroom TV's are standard 26" LCD flat panels

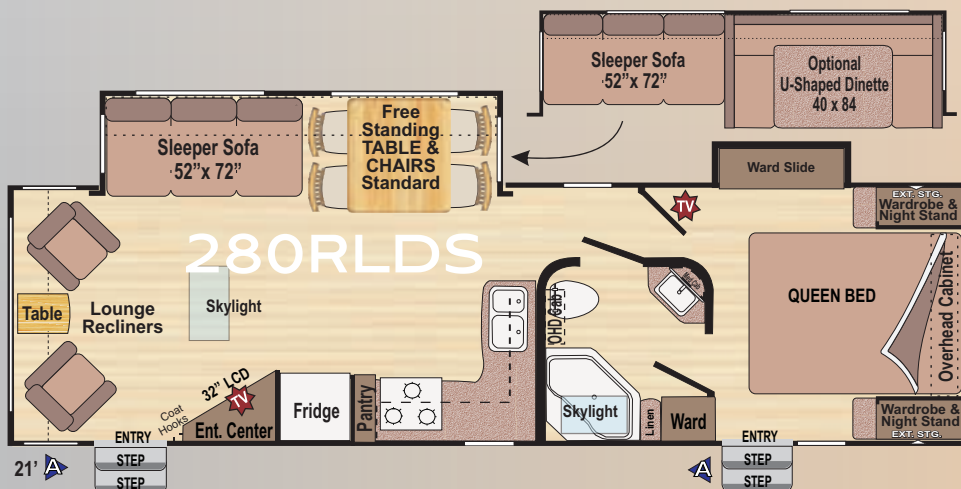

*Wind River*



## Standard

### Interior – Throughout

- \* 26"-32" LCD TV with DVD Home Theatre System
- \* Surround Sound Ceiling Mount Speakers & Sub Woofer
- \* All In One Universal Command Center
- \* Norcold XL Fridge with Hardwood Front Panels
- \* Thermal Insulated Dual Pane Living Area Skylight
- \* Eco Friendly Battery Disconnect
- \* Beaufloor "Outdoors Tough" Flooring – 7 Layers – Cold Cracking Warranty to 50 Below Zero
- \* Roto-torqued "Outdoors Tough" Real Wood Cabinetry (all face frame cabinets)
- \* XL Dinette Drawer System
- \* XL Full Extension Metal Drawer Guides (all drawers)
- \* Two Tone Day / Night Shades – Living Room & Bedroom
- \* Halogen Ceiling Lights
- \* Bullet Reading Lights (Sofa, Chairs, Bedroom)
- \* Real Hardwood Cabinet Doors
- \* Full Width Slide-Out Overhead Cabinets
- \* Hardwood Slide-Out Corner Plinths
- \* Cross Ventilation Slide-Out End Wall Windows
- \* Comfort Suede Furniture with Sofa Throw Pillows
- \* Comfort Style Sleeper Sofa (where applicable)
- \* Comfort Style Lounge Recliners (where applicable)
- \* Coleman 13.5 BTU A/C, Microwave, TV Ant
- \* Metal Single Lever Water Heater Bypass System
- \* Forced Air-Direct Spark Ignition Furnace w/ Thermostat
- \* Welcome to the Outdoors Entry Mat
- \* Eco Friendly Dinette Construction (Aluminum Frame)
- \* 5" Thick – High Density Foam Dinette Cushions

\*Sofa Bed Drawers (230RKS, 250CKS)

### Galley

- \* Stainless Steel Appliances
- \* Silverware Drawer
- \* 22" Sealed Burner Range
- \* Stainless Steel Backsplash & Knife Rack
- \* Rechargeable Flashlight / Night-light
- \* Pot & Pan Drawer Under Range
- \* Gourmet Kitchen Cabinetry & Kitchen Window
- \* Range Cover / Cutting Board Sink Cover
- \* Flip Up Counter Extension (where applicable)
- \* Range Hood w/ 12V Light & Exhaust Fan
- \* Hi-Rise Chrome Single Lever Kitchen Faucet

### Bedroom

- \* Built-in Storage Headboard
- \* "Dream Soft" Pillowtop Mattress
- \* Bedroom Pillows
- \* Strut-Assisted Lift-Up Bed Platform with Below Bed Storage
- \* Fantastic Vent Fan
- \* Two Full Wardrobes, Dual Night-Stands, and Plug-ins
- \* Bullet Reading Lights

### Bath

- \* Residential Style Glass Shower Enclosure
- \* Wall Mounted Hair Dryer
- \* Porcelain Toilet
- \* Chrome Showerhead & Faucets
- \* Bathroom Window (where applicable)
- \* Towel Hooks
- \* Shower Skylight
- \* Wall Switched Ceiling Light
- \* Built-in Wood Medicine Cabinet

### Safety/Convenience

- \* 120V GFI Circuit Protection (Galley/Bath/Patio), 4 Wheel Electric Brakes
- \* Break-Away Emergency Disconnect Brake
- \* Carbon Monoxide Detector/Alarm
- \* Entry Assist Handle
- \* Fire Extinguisher
- \* Propane Detector/Alarm
- \* Smoke Detector/Alarm

### Exterior – Throughout

- \* "Armor Shield" Feather- Light Construction
- \* Laminated Fiberglass Construction
- \* Laminated Fiberglass Slide-Out Floor Construction
- \* Fiberglass Front Cap with Diamond Plate and LED Lights
- \* Eco Friendly Battery Saving Roof Mounted Solar Panel
- \* "True Full Size Outdoor Style" BBQ Hookup Bib & Hose (BBQ sold separately)
- \* Slam Latch XL Thermal Insulated Luggage Doors
- \* Utility Valve Light
- \* One Step Electric Full Length Awning with Rain Dump Arm
- \* Indoor/Outdoor TV Ready
- \* Power Tongue Jack
- \* Easy Ride Rubberized Suspension System
- \* 15" GoodYear Radial Approved Tires & Spare Safety/Warranty (225 – Heavy Ply D Range)
- \* Custom Built Off Road Chassis – Mud Flaps
- \* Rugged A Frame – Protected Junction Box Wiring
- \* Diamond Plate Wrap Bumper
- \* Heavy Duty 6 Lug 5200 LB Axles with Off Road Brake System
- \* Off Road High Impact Wheel Skirts
- \* Diamond Scored Sidewall

### Skirts

- \* Aluminum Wheels
- \* Nut Driven Scissor Jacks (all 4 corners)
- \* Radius Crowned Full Walk On Roof with Ladder
- \* Dual 30# LP Tanks with Flip-Top Cover
- \* Metal Entry Door Catches
- \* Outside Activity Light
- \* Entry Step Lighting
- \* Cooler Sized Lighted Luggage Door Compartments
- \* Black Tank Flush
- \* Exterior Shower
- \* Exterior Speakers

## Options

- \* Bedroom LCD TV w/ DVD Player (N/A 250RLSW)
- \* CSA - - - 
- \* Front Entry Door (230RKS)
- \* 2 Lounge Recliners – Replaces Rear Sofa (250CKS)
- \* Free Standing Dinette (250CKS, 250RLSW, 2702BS, 270RLDS, 280FKS)
- \* Bedroom Carpet
- \* Bike Rack Receiver Hitch
- \* Power Stab Jacks
- \* Energy Saving LED Marker/Tail Lights



- \* Eco-Camping 95 Watt Solar Panel System with 30 AMP Controller



### Mountain Extreme Package Includes:

- \* Dark Tinted Flush Mounted Thermal Pane Windows
- \* R-29 Thermal Roof Barrier Insulation Package
- \* Upgraded XL Furnace (Extreme Camping Heat System)





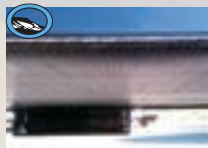

In a 4 Seasons Outdoors RV the entire chassis is enclosed from front to back for both insulation and protection from road debris.



# FOUR SEASONS

*Standard on All Models*

We use Astro-foil (R-15) insulation along the entire length of the floor. Plus an additional wrap around the holding tanks



Fully Enclosed Underbelly



Astro-foil Reflective Blanket Insulation



Astro-foil Insulated Floor & Slide-Out Floors



Insulation Package



Winterization Package

## The Industry Camping Standard:



The Industry Standard: Holding tank dump valves are not enclosed and are exposed to freezing.



The Industry Standard: A single layer of insulation.

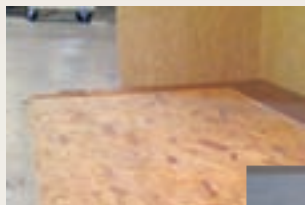

The Industry Standard: Very thin-limited insulation value.



The Industry Standard: No insulation in the slide-out floors

The Industry Standard: Cold and Drafty, Not Designed for Northern Climates.

The Outdoors RV Standard: Warm in the Winter and Cool in the Summer, Perfect for colder Northern US and Canadian climates.

## The Outdoors RV Camping Standard:

The Outdoors RV Standard: Our Dump Valves are located within the Enclosed / Heated underbelly to protect them from freezing.



The Outdoors RV Standard: Insulation is double layered for added protection.



The Outdoors RV Standard: The entire slide out floor is covered with Astro Foil / R-15 Insulation.



The Outdoors RV Standard: 1" thick Thermal Insulated Luggage Doors



"Follow the Wind to Your Dreams"

# Wind River

**All New "Armor Shield" Feather-Light Construction**  
**Dare to Compare - Why don't others do this? \$\$\$**

### Roof Construction:

Rigid Light-Weight Steel Roof Trusses  
Triple Load Bearing Strength



### Aluminum Frame:

Eight Different Areas: Front, Rear, Sides, Slide-Out Wall, Floor, Bed & Luggage Compartments

### Laminated High End 5th Wheel Construction:

Back Wall, Both Sidewalls, Slide-Out Walls, 2" Thick Walls for Strength & Insulation

# Wind River



Outdoors RV Manufacturing is located in a picturesque mountain valley of Eastern Oregon. The focus of this company is to design RV's for the NW and Western Canada, merchandise the products through a hand selected group of dealers with the end goal of having our customers enjoy an Outdoor experience like no other.

The NW and Western Canada will be the targeted area for the products produced here. This area has an incredible percentage of people that enjoy the RV lifestyle and why wouldn't they with the Outdoors right outside most people's backdoor. Our goal is not to be the largest manufacturer in the country nor follow market share graphs. We simply want to design and build great RV's.

Here at Outdoors RV the management team has over 260 years of combined RV experience.

A few examples:

Jim Croxton - General Manager (27 Years)

Darin Nelson - Sales Manager/US Sales (18 Years)

Rod Glass - Canadian Sales Manager (25 Years)

Robin Larsen - Training/Sales (20 years)

Rick Ewing - Service Manager (32 Years)

Terry Fischer - Production Manager (31 Years)

Rick Hudson - Asst. Production Manager (27 Years)

Karen Evans - Sales Administrator (9 Years)

Paul Christensen - Purchasing Manager (35 Years)

James Baker - Product Development (22 Years)

Outdoors RV Manufacturing is a division of Northwood Investments Incorporated

Your Local Outdoors RV Dealer is:



PO BOX 1047  
62582 Pierce Road  
La Grande, OR 97850

Phone 541.624.5500  
Fax 541.963.2448  
[www.outdoorsrvmfg.com](http://www.outdoorsrvmfg.com)