

# "Pure Outdoor Back Country Camping"

## OUTDOORS RV Back Country

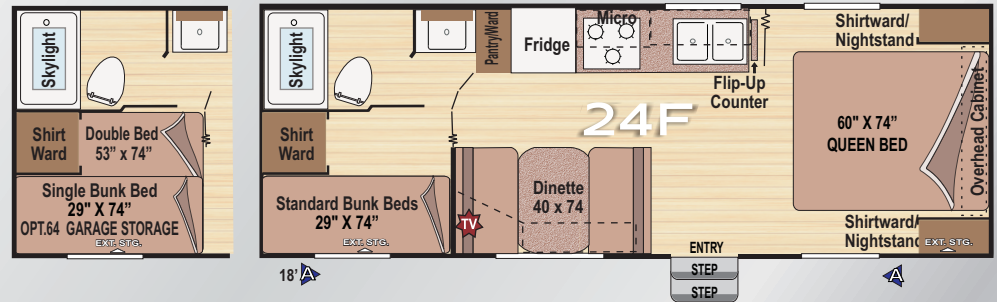
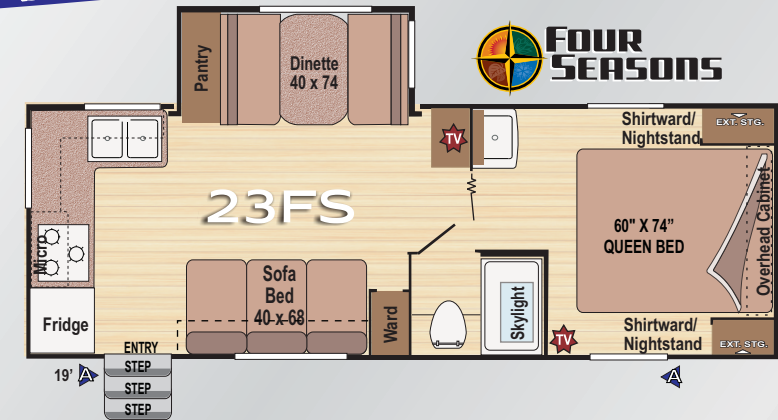
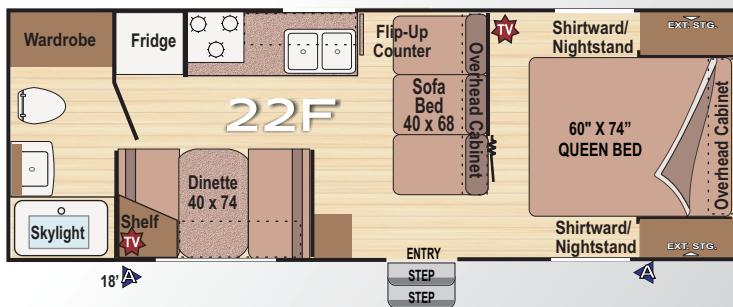
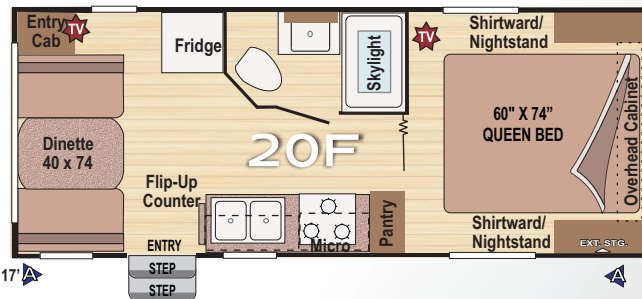
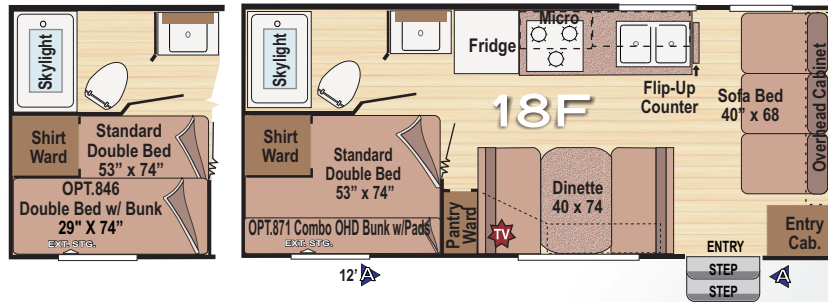

Double Insulation Standard on ALL Models

Indicates pre-wired locations where TV's can be installed

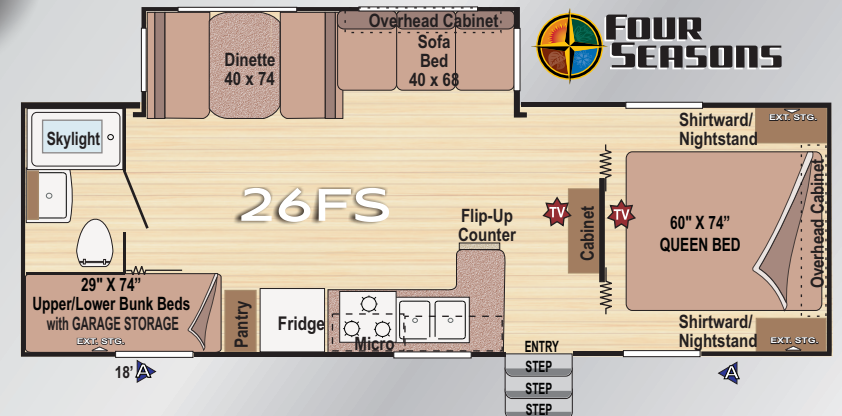

Length' Indicates full length awning.

OUTDOORS RV  
MANUFACTURING

# "Pure Outdoor Back Country Camping"



Weights & Measures	18F	20F	22F	24F	23FS	26FS
<b>Full Featured Dry Weight (lbs)</b>	<b>4050</b>	<b>4100</b>	<b>4250</b>	<b>4350</b>	<b>5700</b>	<b>6050</b>
Cargo Carrying Capacity (lbs)	1750	1700	1750	1650	1800	1850
Hitch Dry Weight (lbs)	500	410	485	505	620	710
Maximum Trailer Weight (lbs)	5800	5800	6000	6000	7500	7900
Length (including hitch)	22'3"	23'9"	26'3"	26'8"	27'6"	29'3"
Fresh Water Holding Tank (gal)	56	56	56	56	56	56
Grey Water Holding Tank (gal)	40	40	40	40	40/40	40
Black Water Holding Tank (gal)	40	40	40	40	40	40
Propane Capacity (lbs)	60	60	60	60	60	60
Heavy Duty 5 Lug Axles (lbs)	3500 (2)	3500 (2)	3500 (2)	3500 (2)		
Heavy Duty 6 Lug Axles (lbs)					5200 (2)	5200 (2)
Goodyear Tire Size (load range)	ST205/75 15C	ST205/75 15C	ST205/75 15C	ST205/75 15C	ST225/75 15D	ST225/75 15D

## \*All dry weights are calculated on full featured production units

\*Verify the towing capacity of your tow vehicle. If you don't know or aren't sure, you can ask your automotive dealership or contact your tow vehicle manufacturer. \*All weights above are average approximations and may vary. Weights are calculated before adding options. \*Specifications, weights and prices are subject to change without notice.



# Outdoors RV Mfg

La Grande, OR \* 541-624-5500

## WWW.OUTDOORSRVMFG.COM

### "Welcome to the Outdoors" Back Country Package

Norcold 6.3 cu ft Fridge with Plantation Cherry Prefinish Panels  
Dinette Drawer System (1 Pot & Pan Drawer)  
Knife Rack behind Range  
Full Extension Metal Drawer Guides (All Drawers)  
Black Tank Flush  
Exterior Shower  
Extra Counter Space - Range Cover, 2 Sink Lids, Flip Up Counter  
Microwave / TV Ant / CD Player  
DSI Water Heater with Bypass  
Residential Shower Surround Tub Walls  
Mini-blinds  
Bathroom Heat Duct  
Porch Light  
3 Burner Cooktop with 22" Oven\*\*  
Bath Skylight  
Awning  
Foot Flush Toilet  
Forced Air Direct Spark Ignition Furnace with Thermostat  
Granite Designed Countertops  
Bathroom Towel Bars  
Front Walk Around Queen Bed\*\*  
Dual Night Stands and Shirt Wards\*\*  
Comfort Style Residential Sofa\*\*  
Sofa Throw Pillows (2)\*\*

### Options

CSA   
Coleman 13.5 A/C

### Built "Outdoors Tough" Back Country Package

Double Insulation  
Double High Front Diamond Plate  
15" GoodYear Radial Trailer Approved Tires Safety/Warranty  
15" GoodYear Spare Radial Trailer Approved Tire with Carrier  
Custom Built Off Road Chassis  
Rugged A-Frame - Protected Junction Box Wiring  
Diamond Plate Wrap Bumper  
Heavy Duty 5 Lug 3500 LB Axles with Off Road Brake System  
Extra Ground Clearance Straight Axles with Easy Lube Hubs  
Beaufloor "Outdoor Tough" Flooring - 7 Layers - Cold Cracking Warranty to -50  
Roto-Torqued Outdoors Tough Real Wood Cabinetry (all cabinets)  
Mud Flaps  
Nut Driven Scissor Jacks (all 4 corners)  
Radius Crowned Full Walk On Roof  
Dual 30# LP Tanks with Flip-Top Cover  
Metal Entry Door Catches  
Off Road Clearance Lights  
5" Thick - High Density Foam - Dinette Cushions  
Fiberglass Wall-Cutouts - Dinette Construction  
4-Wheel Electric Brakes with Breakaway Switch  
Safety Package - Includes Propane Detector, Fire Extinguisher  
& Carbon Monoxide Detector  
Tinted Windows  
Factory Winterization with Valve  
Cooler Sized Luggage Doors\*\*

\*\* Most Models

### 23FS/26FS

Four Seasons Camping - Designed for Mountain States & Western Canada  
Fully Enclosed / Heated / Insulated Underbelly / Mountain Insulation  
15" GoodYear Radial Trailer Approved Tires Safety/Warranty (Heavy Ply D Range - ST225)  
15" GoodYear Spare Radial Trailer Approved Tire with Carrier (Heavy Ply D Range - ST225)  
Laminated Fiberglass Slide-Out Floor  
Heavy Duty 6 Lug 5200 LB Axles with Off Road Brake System